

13 cm Koaxiallautsprecher / 5" Coaxial Speakers

FX 13 Art. No. 4570 – 4 Ω



13 cm (5") 2-Wege-Koaxiallautsprecher mit Euro-Normkorb. Integrierte Frequenzweiche (Kondensator) für den Hochtöner. Einfache Montage in Fahrzeugen mit Einbauorten für 13-cm-Lautsprecher. Wasserfeste Polypropylenmembran.

Anwendungsmöglichkeiten: Fahrzeuge, Reisemobile
Zubehör: Schutzgitter (Art.-Nr. 4643, 4667). Adapterring (Art.-No. 4775)

13 cm (5") 2-way coaxial loudspeaker with standard basket. Integrated crossover (capacitor) for the tweeter. Straightforward installation in vehicles with cutouts for 13 cm speakers. Waterproof PP-cone.

Typical applications: Vehicles, Mobile homes
Accessories: Protective grille (Art.-No. 4643, 4667). Adapter ring (Art.-No. 4775)



Art. No. 4667 *)



Art. No. 4643 *)

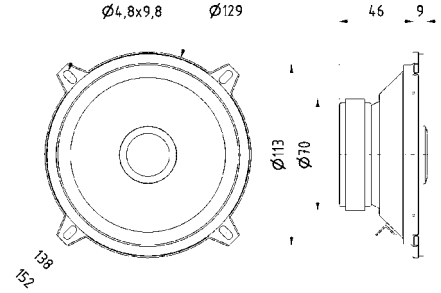
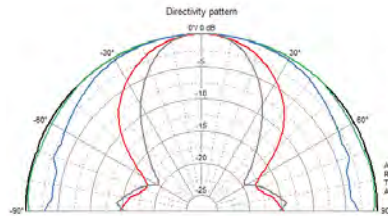

FX 13
23.1106



ARF 13
Art. No. 4775

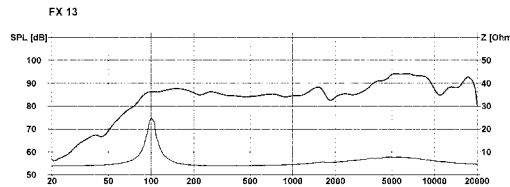

PX 13 Art. No. 4603 – 4 Ω



13 cm (5") 2-Wege-Koaxiallautsprecher mit Euro-Normkorb und Piezo-Hochtöner. Einfache Montage in Fahrzeugen mit Einbauorten für 13-cm-Lautsprecher.

Anwendungsmöglichkeiten: Fahrzeuge, Reisemobile
Zubehör: Adapterring (Art.-No. 4775), Schutzgitter (Art.-No. 4643, 4667)

13 cm (5") 2-way coaxial loudspeaker with standard basket and piezoelectric tweeter. Straightforward installation in vehicles with cut-outs for 13 cm speakers.

Typical applications: Vehicles, Mobile homes

Accessories: Adapter ring (Art.-No. 4775), protective grille (Art.-No. 4643, 4667)

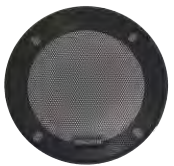

Art. No. 4667 *)



Art. No. 4643 *)

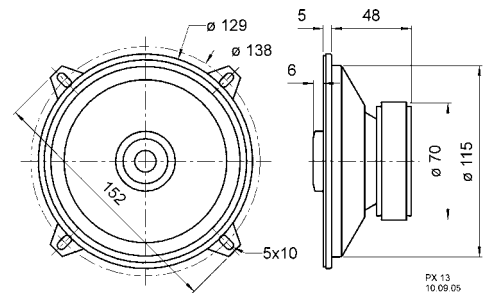
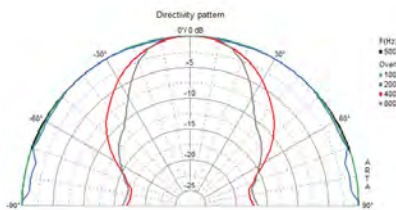

PX 13
10.09.05

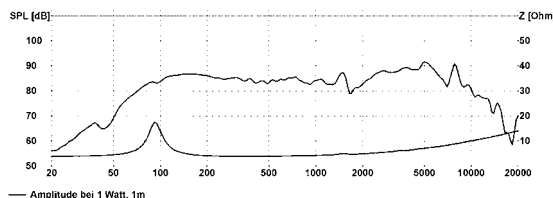

— Amplitude bei 1 Watt, 1m



ARF 13
Art. No. 4775

		FX 13	PX 13
Nenn-/Musikbelastbarkeit	Rated/maximum power	30 W / 50 W	20 W / 30 W
Impedanz	Impedance	4 Ω	4 Ω
Übertragungsbereich (-10 dB)	Frequency response (-10 dB)	60-20000 Hz	60-15000 Hz
Mittlerer Schalldruckpegel	Mean sound pressure level	85 dB (1 W/1 m)	84 dB (1 W/1 m)
Grenzauslenkung x _{mech}	Excursion limit x _{mech}	± 2 mm	± 2 mm
Resonanzfrequenz	Resonance frequency	100 Hz	95 Hz
Obere Polplattenhöhe	Height of front pole-plate	4 mm Ø	3 mm
Schwingspulendurchmesser	Voice coil diameter	20 mm Ø / 14 mm Ø	20 mm
Wickelhöhe	Height of winding	6 mm	5,5 mm
Schallwandöffnung	Cutout diameter	115 mm Ø	116 mm Ø
Gewicht netto	Net weight	0,51 kg	0,480 kg

*) Details und Zeichnungen siehe Seite 175-179 / Details and drawings see page 175-179