

AlGaInP Visible Laser Diode **ADL-66201TL**

DATE:2005/9/9 Ver 1.0

★660nm 20mW 60°C

Reliable High Power Operation

PRELIMINARY

•Features

1. Low operating current
2. High efficiency
3. High precision package
4. High power operation

•Applications

1. Laser pointers
2. Industrial laser markers / measuring instruments
3. High visibility applications

•Absolute maximum ratings

Parameter	Symbol	Condition	Rating	Unit
Light output power	P _O	CW	22	mW
Reverse voltage (LD)	V _{RL}	-	2	V
Reverse voltage (PD)	V _{RD}	-	30	V
Forward current (PD)	I _{FD}	-	10	mA
Case temperature	T _C	-	-10~+60	°C
Storage temperature	T _S	-	-40~+85	°C

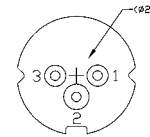
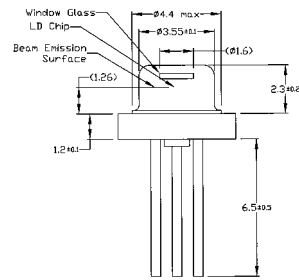
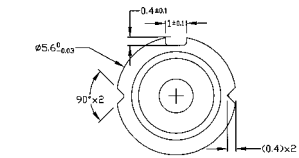

() denoted typical value

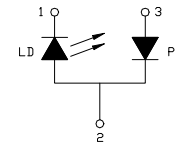

•Electrical and optical characteristics (T_c=22.5±2°C)

Parameter	Symbol	Min.	Typ.	Max.	Unit	Conditions
Peak wavelength	λ	650	658	665	nm	P _o =20mW
Threshold current	I _{th}		42	50	mA	
Operating current	I _{op}		70	75	mA	P _o =20mW
Operating voltage	V _{op}	2.0	2.3	2.5	V	P _o =20mW
Differential efficiency	η	0.5	0.8	1.0	mW/mA	P _o =15~20mW
Monitor current	I _m	0.05	0.15	0.5	mA	P _o =20mW, V _{RD} =0V
Parallel divergence angle	θ	6	7	10	deg	P _o =20mW
Perpendicular divergence angle	θ _⊥	13	16	22	deg	
Parallel FFP deviation angle	Δθ	-2	0	+2	deg	
Perpendicular FFP deviation angle	Δθ _⊥	-2	0	+2	deg	
Emission point accuracy	ΔxΔyΔz	-80	0	+80	um	

•Precautions

- Do not operate the device above maximum ratings. Doing so may cause unexpected and permanent damage to the device.
- Take precautions to avoid electrostatic discharge and/or momentary power spikes. A change in the characteristics of the laser or premature failure may result.
- Proper heat sinking of the device assures stability and lifetime. Always ensure that maximum operating temperatures are not exceeded.
- Observing visible or invisible laser beams with the human eye directly, or indirectly, can cause permanent damage. Use a camera to observe the laser.
- No laser device should be used in any application or situation where life or property is at risk in event of device failure.
- Specifications are subject to change without notice. Ensure that you have the latest specification by contacting us prior to purchase or use of the product.

** For reference only. Contents above are subject to change without notice.*