

REV.	DESCRIPTION	DRAWN	CHECKED	APPROVED
A	NEW RELEASE	YCH 03/11/11'	~	

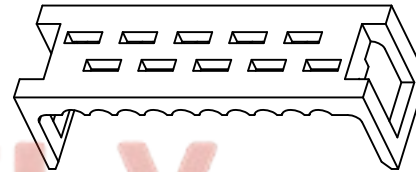
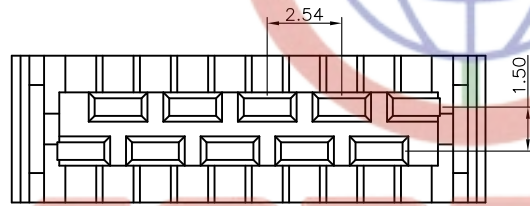
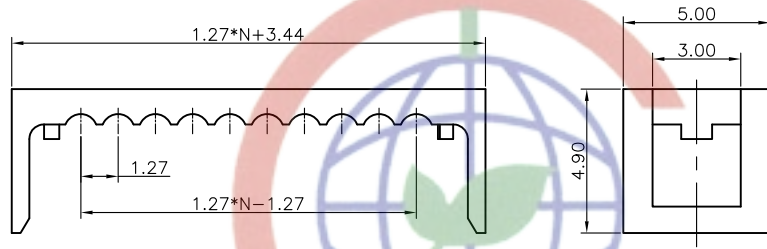

COVER

NOTES:

- MATERIAL
  - INSULATOR:THERMOPLASTIC(UL 94V-0).
  - CONTACT: COPPER ALLOY.
- SPECIFICATION
  - TEMPERATURE RANGE:-40°C~+105°C.
  - CONTACT RESISTANCE:30mΩ max.
  - INSULATION RESISTANCE:1000MΩ min.
  - DIELECTRIC WITHSTANDING VOLTAGE:AC 500V PER MINUTE.
- PRODUCT NUMBER CODE:  
DS1015-02- X X X

CONTACT PLATING  
2: NICKEL+GOLD FLASH  
6: FULL TIN  
8: FULL GOLD FLASH

HOUSING COLOR  
R:RED

No. OF CONTACTS  
04 06 08 10  
12 14 16 18  
20 24

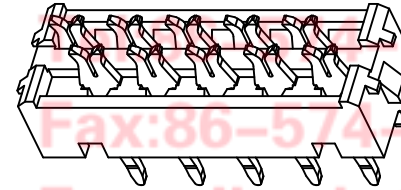
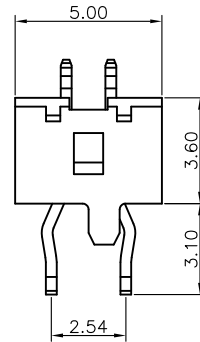
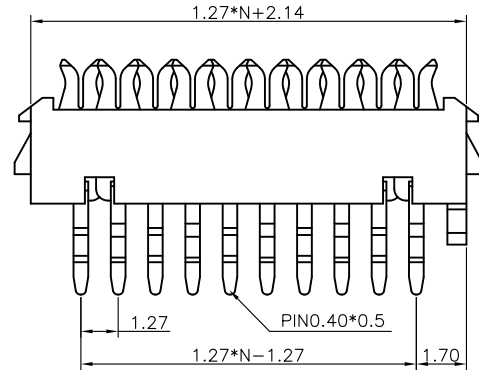

HOUSING

GENERAL TOLERANCE		ANGLE TOLERANCE		PROJECTION	TITLE
X.	±0.60	X.	±5°	mm	MICRO MATCH
.X	±0.38	.X	±3°		PADDEL BOARD CONNECTOR
.XX	±0.25	.XX	±2°		SHEET SIZE A4
DRAWING TYPE		CUSTOMER		SERIES	DS1015-02 SERIES
SCALE		1:1	SHEET	1 OF 1	
DRAWING NO.		C-DS1015-02-XXX			

**晨翔电子有限公司**  
**CONNFLY CONNFLY ELECTRONIC CO. LTD**

Tel: 86-574-6350878  
 Fax: 86-574-63510817  
 E-mail: sale@zhenqin.com.cn  
 Http://www.connfly.com