

Rev	AWO #	Description	Date	Appr
-		RELEASED	12/24/10	

APPROVED: \_\_\_\_\_  
 DATE: \_\_\_\_\_ TITLE: \_\_\_\_\_

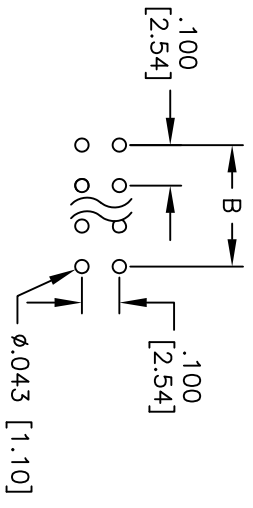
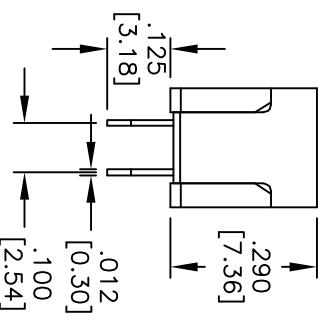
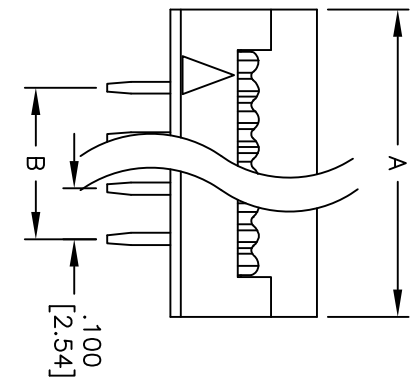
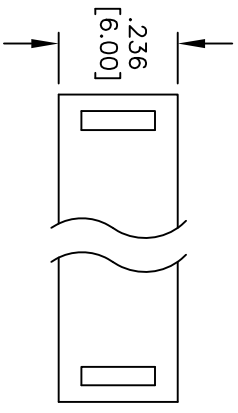

RECOMMENDED PCB LAYOUT

Positions: 6, 8, 10, 12, 14, 16, 18, 20, 24, 26  
 30, 34, 36, 40, 50, 60, 64  
 A = .100 [2.54] x No. of Spaces per Row + .315 [7.99]  
 B = .100 [2.54] x No. of Spaces per Row

**SPECIFICATIONS:**

**Material:**

Insulator: PBT, glass filled, rated UL 94V-0  
 Insulator color: Black

**Contacts:**

Brass

**Plating:**

Gold flash over Nickel underplate on contact area,  
 Tin over Copper underplate on tails

**Electrical:**

Operating voltage: 250 VAC max.

**Current rating:**

1 Amp max.

**Contact resistance:**

30 mohms max. initial

**Insulation resistance:**

1,000 Mohms min @ 500 VDC.

**Dielectric withstanding voltage:**

500 VAC for 1 minute

**Temperature Rating:**

Operating temperature: -40°C to +105°C

**Environmental:**

Lead free, RoHS compliant



UNLESS OTHERWISE SPECIFIED  
 ALL DIMENSIONS ARE INCHES [MM]

TOLERANCES: EXCEPT AS NOTED	INCHES	HOLES
.X	± .10	± .10
.XX	± .020	± .015
.XXX	± .015	± .010

**ADAM TECH**  
 909 Railway Avenue, Union, NJ 07083  
 Phone: 908-687-5000 Fax: 908-687-5710

DRAWN	AY	12/24/10	SIZE	PART NO.	REV.
CHECKED	JL	12/24/10	X	FTR-XX-SG	-
APPROVED			REF: S00087T	SCALE: NTS	SHEET 1 OF 1